

TECHNICAL FEATURES FOR CYLINDERS USED IN HARSH ENVIRONMENTS CARATTERISTICHE TECNICHE CILINDRI ANTICORROSIONE

Anticorrosive Vesta cylinders, **DSM, DSA, XPT, XJS** and **XJSS** are suitable for use in aggressive environment, such as the food or the chemical industries.

DSM e XJSS series are available also with fluoro rubber seals (VITON), for high temperature.

All cylinders follows ISO 6432 and ISO VDMA 6431 standards (stroke tolerance include).

For further information on the resistance of materials to aggressive agents, please contact our technical sales department.

I cilindri anticorrosione Vesta serie DSM, DSA, XPT, XJS e XJSS sono progettati per l'impiego in ambienti aggressivi, quali l'industria alimentare o chimica. I modelli DSM e XJSS (completamente in acciaio inox) sono fornibili con tutte le guarnizioni in VITON.

Tutti i cilindri anticorrosione rispettano gli standard ISO 6432 e ISO VDMA 6431 (incluse le tolleranze sulle corse dei cilindri).

Per informazioni sul grado di resistenza in ambienti specifici contattare il nostro ufficio tecnico-commerciale.

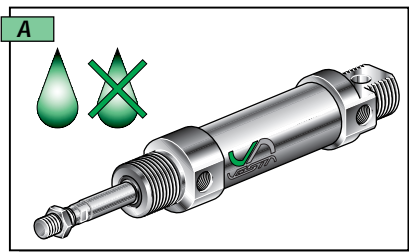

Lubrication not required.
Possibilità di funzionamento continuo privo di lubrificazione.

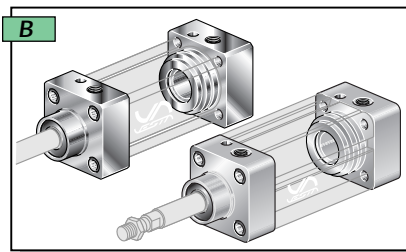

X5 Cr Ni 1810 stainless steel caps for DSM and XJSS, acetalic resin for XJS e XPT.
Teste inox X5 Cr Ni 1810 per DSM e XJSS, resina acetica per XJS e XPT.

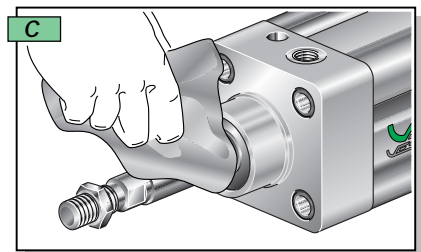

Caps easy to clean, due to their shape.
Le teste sono facilmente pulibili perché non scaricate esternamente.

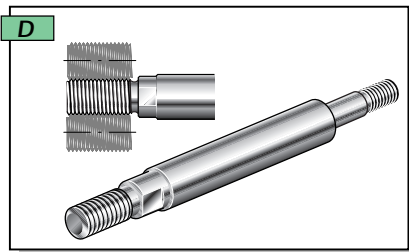

Piston rods in rolled stainless steel X5 Cr Ni 18-10.
Steli in acciaio INOX X5 Cr Ni 18-10 rollato.

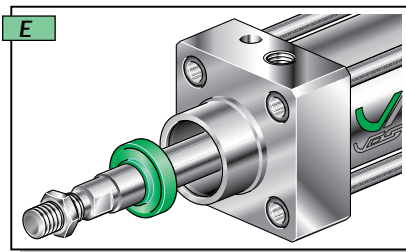

Poliurethan nose seal.
Guarnizione dello stelo realizzata in poliuretano.

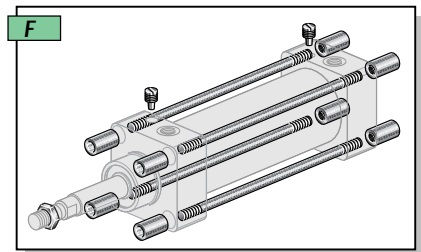

All external particulars are in X10 Cr Ni S 18-09.
I particolari a contatto con gli agenti esterni sono in acciaio inox X10 Cr Ni S 18-09.

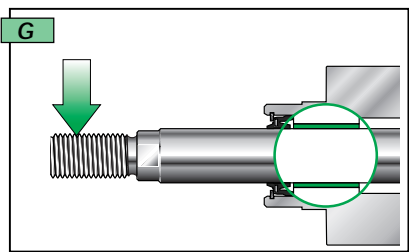

Self lubricating bearing in a copper-steel alloy, with teflon covering.
Boccole autolubrificanti in acciaio ramato con deposito in Teflon.

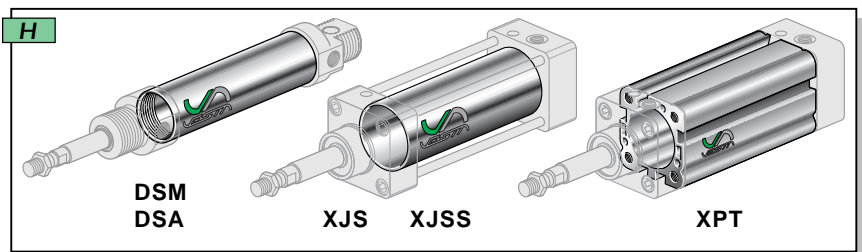

X5 Cr Ni 18-10 stainless steel tube for DSM, XJS and XJSS series.
For XPT series, anodized aluminium.

Camicie realizzate in acciaio inox X5 Cr Ni 18-10 per le versioni DSM, XJS e XJSS. La versione XPT è ricavata da profilato di alluminio anodizzato.



SERIE XPT FOR AGGRESSIVE ENVIRONMENT CONDITIONS, VDMA - ISO 6431
CILINDRI PER AMBIENTI AGGRESSIVI, VDMA - ISO 6431

With magnetic piston / Con pistone magnetico

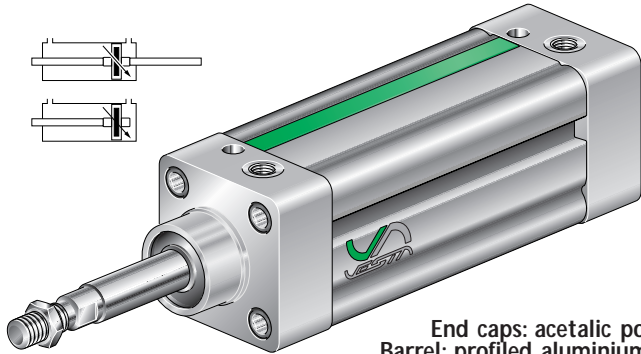

End caps: acetalic polymer
 Barrel: profiled aluminium tube
 Piston-rod: stainless steel.
 Testate: resina acetaltica
 Camicia: profilato di alluminio
 Stelo: acciaio inox

XPT /

Bore / Alesaggio (mm):

- Ø32 32
- Ø40 40
- Ø50 50
- Ø63 63
- Ø80 80
- Ø100 ... 100

P Through rod cylinder
 Cilindro stelo passante

Stroke / Corsa (mm):

Bore Alesaggio	Standard stroke / Corse Standard																	
	25	50	80	100	125	160	200	250	300	350	400	450	500	600	700	800	900	1000
32	•	•	•	•	•	•	•	•	•	•	•	•	•					
40	•	•	•	•	•	•	•	•	•	•	•	•	•					
50	•	•	•	•	•	•	•	•	•	•	•	•	•					
63	•	•	•	•	•	•	•	•	•	•	•	•	•					
80	•	•	•	•	•	•	•	•	•	•	•	•	•	•	•	•	•	•
100	•	•	•	•	•	•	•	•	•	•	•	•	•	•	•	•	•	•

Effective cushion length
 Lunghezza utile ammortizzatore

Bore Alesaggio	Length Lunghezza
32	24
40	27
50	30
63	30
80	36
100	38

XPT cylinder fixing see:
 Fissaggi per cilindri XPT vedi:
 **Pag. A-43; A-47 ÷ A-48.**

Characteristic reed switches see:
 Caratteristiche finecorsa magnetici:
 **Pag. A-19.**

TECHNICAL FEATURES

- End caps Acetalic polymer (Zellamid 900).
- Piston rod Stainless steel X5 Cr Ni 18-10.
- Barrel Extruded profiled and anodized aluminium tube.
- Seals Rod seal in polyuretanic material, other seals in NBR.
- Cushion Very efficient, micrometric control.

- Environment temperature range -10 °C ÷ +70 °C.
- Temperature range of medium 0 °C ÷ +40 °C.
- Lubrication Not required.
- Medium Filtered air.
- Max operating pressure range 10 bar.

CARATTERISTICHE TECNICHE

- Testate Resina acetaltica (Zellamid 900).
- Stelo Acciaio inox X5 Cr Ni 18-10.
- Camicia Tubo profilato ed anodizzato d' alluminio.
- Guarnizioni Dello stelo in poliuretano, altre in NBR.
- Ammortizzatori Di notevole efficacia, con regolazione micrometrica.

- Temperatura ambiente -10 °C ÷ +70 °C.
- Temperatura fluido 0 °C ÷ +40 °C.
- Lubrificazione Non necessaria.
- Fluido Aria filtrata.
- Pressione max d'esercizio 10 bar.

XPT .. /... SINGLE ROD / CILINDRO BASE STELO SEMPLICE

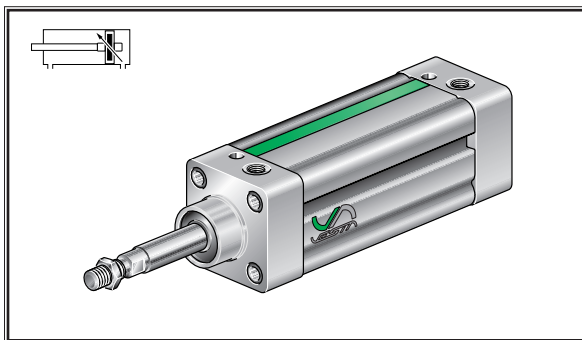

Bore Alesaggio	A	B	C	D	E	F	G	H	I	L	M	N	O	P	BG	CH	Code Codice
32	120	94	26	30	12	M10x1,25	20	7	19	4	47	32,5	M6	G1/8	15	10	XPT 32/...
40	135	105	30	35	16	M12x1,25	24	8	22	4	54	38	M6	G1/4	15	13	XPT 40/...
50	143	106	37	40	20	M16x1,5	32	14	23	2	66	46,5	M8	G1/4	15	17	XPT 50/...
63	158	121	37	45	20	M16x1,5	32	13	24	4	78	56,5	M8	G3/8	15	17	XPT 63/...
80	174	128	46	45	25	M20x1,5	40	20	26	2	98	72	M10	G3/8	18	21	XPT 80/...
100	189	138	51	55	25	M20x1,5	40	25	26	2	115	89	M10	G1/2	18	25	XPT 100/...

XPT .. /... P THROUGH ROD / STELO PASSANTE

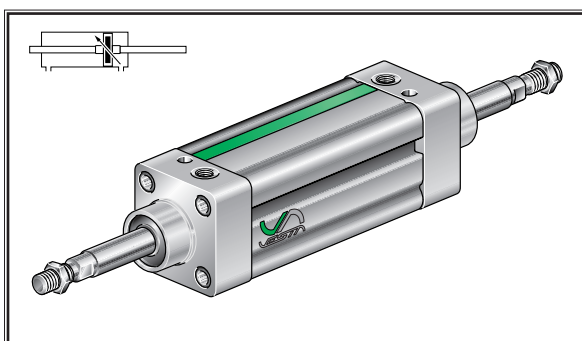

Bore Alesaggio	A	B	C	D	E	F	G	H	H1	I	M	N	O	P	BG	CH	Code Codice
32	120	94	26	30	12	M10x1,25	20	7	26	19	47	32,5	M6	G1/8	15	10	XPT 32/... P
40	135	105	30	35	16	M12x1,25	24	8	30	22	54	38	M6	G1/4	15	13	XPT 40/... P
50	143	106	37	40	20	M16x1,5	32	14	37	23	66	46,5	M8	G1/4	15	17	XPT 50/... P
63	158	121	37	45	20	M16x1,5	32	13	37	24	78	56,5	M8	G3/8	15	17	XPT 63/... P
80	174	128	46	45	25	M20x1,5	40	20	46	26	98	72	M10	G3/8	18	21	XPT 80/... P
100	189	138	51	55	25	M20x1,5	40	25	51	26	115	89	M10	G1/2	18	25	XPT 100/... P

STAINLESS STEEL FIXING / ACCESSORI DI FISSAGGIO INOX PER CILINDRI ANTICORROSIONE

Vesta fixing accessories shown here are manufactured in X5 Cr Ni 18-10 stainless steel .
Dimensions correspond to ISO 6432 standard (see pages A-10 and A-11).

I fissaggi Vesta a fianco illustrati sono realizzati in acciaio inox X5 Cr Ni 18-10 per poter resistere all'ambiente di destinazione del cilindro anticorrosione e comunque mantengono le dimensioni di ingombro dei corrispondenti fissaggi ISO 6432 descritti a pagina A-10 e A-11 del presente catalogo.

ISO 6432

FOR / PER DSM - DSA Ø12 ÷ Ø25

REAR HINGE HORIZONTAL MOUNTING
MONTAGGIO A CONTROCERNIERA **ASNX/..**

Bore Alesaggio	Fixing code Codice fissaggio
12	ASNX/12
16	ASNX/16
20	ASNX/20
25	ASNX/25

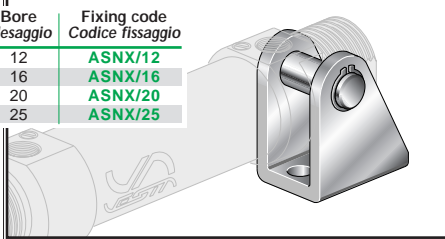

END-CAP NUT
DADO TESTATA **DMNX ../..**

Bore Alesaggio	Fixing code Codice fissaggio
12	DMNX12/16
16	DMNX12/16
20	DMNX20/25
25	DMNX20/25

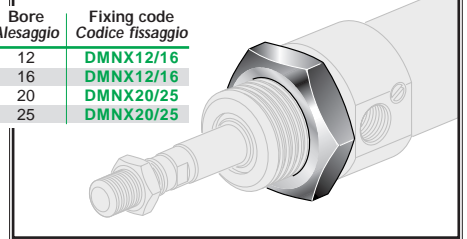

FLANGE MOUNTING
MONTAGGIO A FLANGIA **FLNX/..**

Bore Alesaggio	Fixing code Codice fissaggio
12	FLNX/12
16	FLNX/16
20	FLNX/20
25	FLNX/25

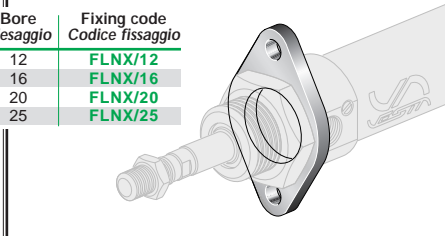

FOOT MOUNTING
MONTAGGIO A PIEDINI **PNX/..**

Bore Alesaggio	Fixing code Codice fissaggio
12	PNX/12
16	PNX/16
20	PNX/20
25	PNX/25

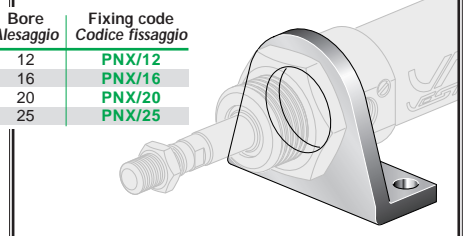

ISO 6431 & ISO 6432

FOR / PER DSM; DSA; XPT; XJS; XJSS Ø12 ÷ Ø100

CLEVIS (ROD) MOUNTING
FORCELLA STELO **FSNX/..**

Bore Alesaggio	Fixing code Codice fissaggio
12	FSNX/6x1
16	FSNX/6x1
20	FSNX/8x1,25
25	FSNX/10x1,25
32	FSNX/10x1,25
40	FSNX/12x1,25
50	FSNX/16x1,5
63	FSNX/16x1,5
80	FSNX/20x1,5
100	FSNX/20x1,5

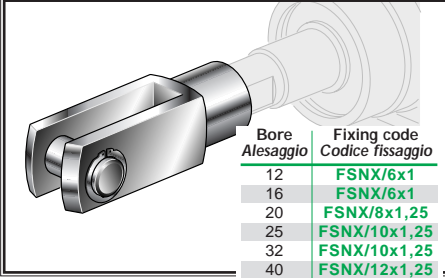

ROD NUT
DADO STELO **DSNX/..**

Bore Alesaggio	Fixing code Codice fissaggio
12	DSNX/6x1
16	DSNX/6x1
20	DSNX/8x1,25
25	DSNX/10x1,25
32	DSNX/10x1,25
40	DSNX/12x1,25
50	DSNX/16x1,5
63	DSNX/16x1,5
80	DSNX/20x1,5
100	DSNX/20x1,5

